

<b>ARCHITECTURAL STANDARDS</b>	CEILINGS
<b>PRODUCT DATA SHEET</b>	
SECTION 9: CEILINGS	K40

**PREFERRED SUPPLIER INFORMATION**  
 NBS REFERENCE K40  
 MANUFACTURER:  
**ARMSTRONG CEILINGS**  
 Address Harman House, 1 George Street  
 Uxbridge, Middlesex UB8 1QQ  
 Tel 07917843941 / 0800371849  
 Fax 01895258188  
 Website: [www.armstrong-ceilings.co.uk](http://www.armstrong-ceilings.co.uk)  
 Supplier: Cc Karamjit Sidhu <KSidhu@armstrongceilings.com>

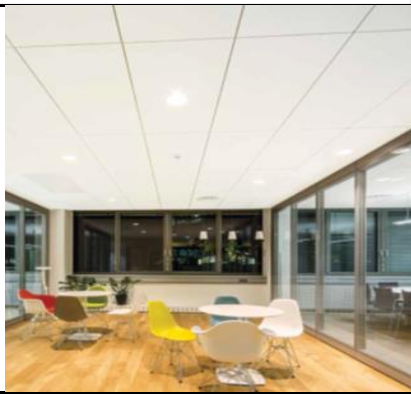

**PRODUCT DESCRIPTION**  
 ICL APPROVED SPECIFICATION  
 Range: Optima  
 Product Coc BP2327  
 Description: Fine Textured acoustic glass fibre tiles with durability facing  
 Application: Halls of Residence/ Office/Teaching Area  
 Material Fibre Glass  
 Size 600 X 600 mm  
 Other Featu Cleanable/ High Light Reflectance/Excellent Acoustic Absorption Properties  
 Environmen 77% Recycled content/Tested against EN 143964-E1 rating for emissions  
 Recyclable: Non-Recyclable  
 Warranty: 15 Year manufacturers guarantee  
 Production: Made in Pensacola - USA

**TYPICAL NBS SPECIFICATION**  
**K 40 CEILING TILE**  
 Standard: Approved ceiling installation to Imperial College London Architectural Standards  
 Range Optima  
 Manufacturer: Armstrong Ceilings , Harman House, 1 George Street, Uxbridge Middlesex, UB8 1QQ  
 Colour/Pattern: Armstrong Global White  
 Ceiling Type Fine textured acoustic glass fibre tiles with high durability facing  
 Grid spacing 600 x 600 mm  
 Accessories: Infill Units Fully Demountable 217 Suspension System Trulok Prelude Suspension System  
 Top Fixings As recommended by ceiling contractor  
 Hangers Trulok BP AW950 Suspension Wire  
 Grid Type Exposed 24 mm Grid System 219 Perimeter Trims Trulok Perimeter Trim BP T 1932H  
 Fixings (perimeters) As recommended by ceiling contractor  
 Fixing (centres) (maximum) 450 mm



